



MEETING & EVENTS FACILITIES GUIDE

Turning Stone[®]
RESORT | CASINO

Meetings

Our flexible meeting and convention space is in a class apart and totals 125,000 square feet, accommodating groups from 15 to 2,000. The largest function room is our Event Center, with 33,000 square feet. Additionally, 26 breakout rooms present more options. Turning Stone provides the perfect blend of facilities for intimate meetings, product launches, professional and educational gatherings, as well as full-scale conventions. Our staff provides expert assistance when planning catered meals, audio-visual needs, team-building programs and a variety of contests and tournaments, as well as spa treatments, recreational outings and fitness pursuits.



Conference Center

Large or small, your group will be effectively and pleasantly accommodated in our Conference Center. 22,459 square feet of space allows for exhibits, seminars, meals, meetings and company parties in a ballroom setting. Six of the nine breakout rooms can be combined to form a large, open space. This flexible design permits configuring the space for your programs, allowing you to move from your pre-function reception to your afternoon's exhibition and post-function dinner with ease. Each room is fully equipped to meet your audio-visual, refreshment and other program needs.

- Over 22,459 sq. ft. of meeting space
- Meeting rooms with flexible configurations
- Capable of handling banquets for up to 1,000 people
- Ballroom décor
- Easy ground-level load-in accessibility
- In-house AV department

First Floor

KEY

- A Tuscarora
- B Cayuga
- C Onondaga
- D Seneca
- E Mohawk
- F Oneida

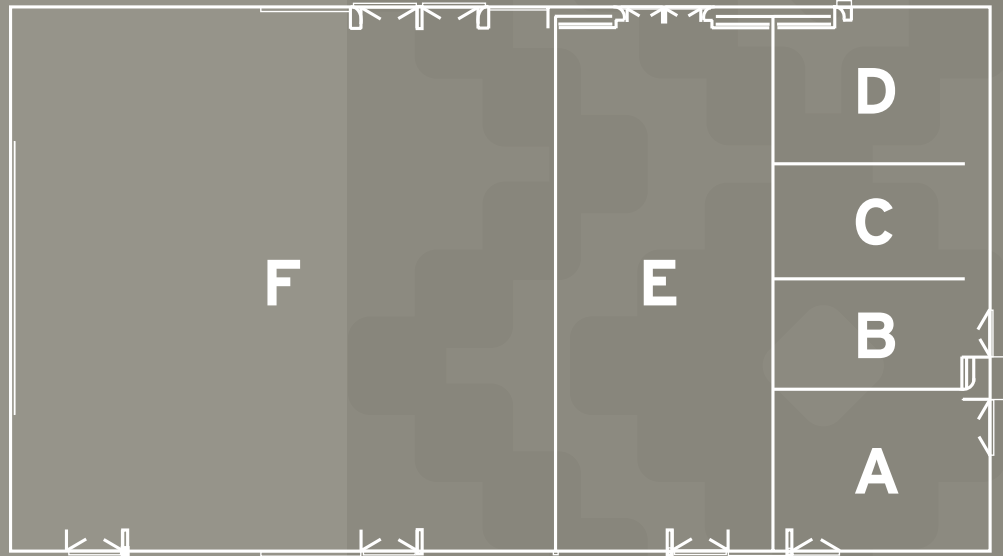

ROOM	DIMENSIONS	THEATER	CLASSROOM	BANQUET	SQ. FT.
Tuscarora	33'x53'	126	72	72	1,579
Cayuga	27'x52'	108	63	60	1,337
Onondaga	26'x32'	108	63	60	1,252
Seneca	33'x32'	126	72	72	1,609
Mohawk	116'x46'	540	270	300	5,212
Oneida	119'x100'	624	514	640	11,465
Combined	120'x206'	1,632	1,054	1,000	22,504

MINIMUM CEILING HEIGHT - 12 - 16 FEET

Second Floor

KEY

- A Chautauqua
- B Canandaigua
- C Saranac

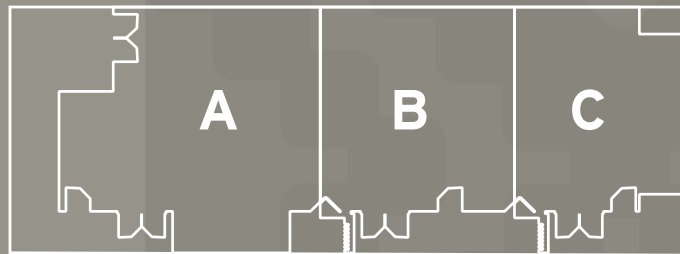

ROOM	DIMENSIONS	THEATER	CLASSROOM	BANQUET	SQ. FT.
Chautauqua	31'x33'	49	27	40	836
Canandaigua	26'x24'	40	27	40	618
Saranac	26'x21'	45	27	30	499

MINIMUM CEILING HEIGHT - 10 FEET



Tower Meeting Rooms

These are the perfect rooms for small-group discussions, seminars and boardroom-style meetings. Ranging in size from 400 square feet to more than 900 square feet, these seven rooms receive natural light and provide easy access to the Event Center and Atrium, as well as the Upstate Tavern and TS Steakhouse. An escalator ride provides participants with an easy route back to the Conference Center. Located near The Tower hotel, and adjacent to the business center, The Tower Meeting rooms are a short walk from the parking garage, The Lodge and the Conference Center.

- Seven boardroom-style meeting rooms from 400 to more than 900 sq. ft. each
- Easy access to the parking garage, the hotels, Conference Center and gaming floor
- Audio-Visual support available on request.

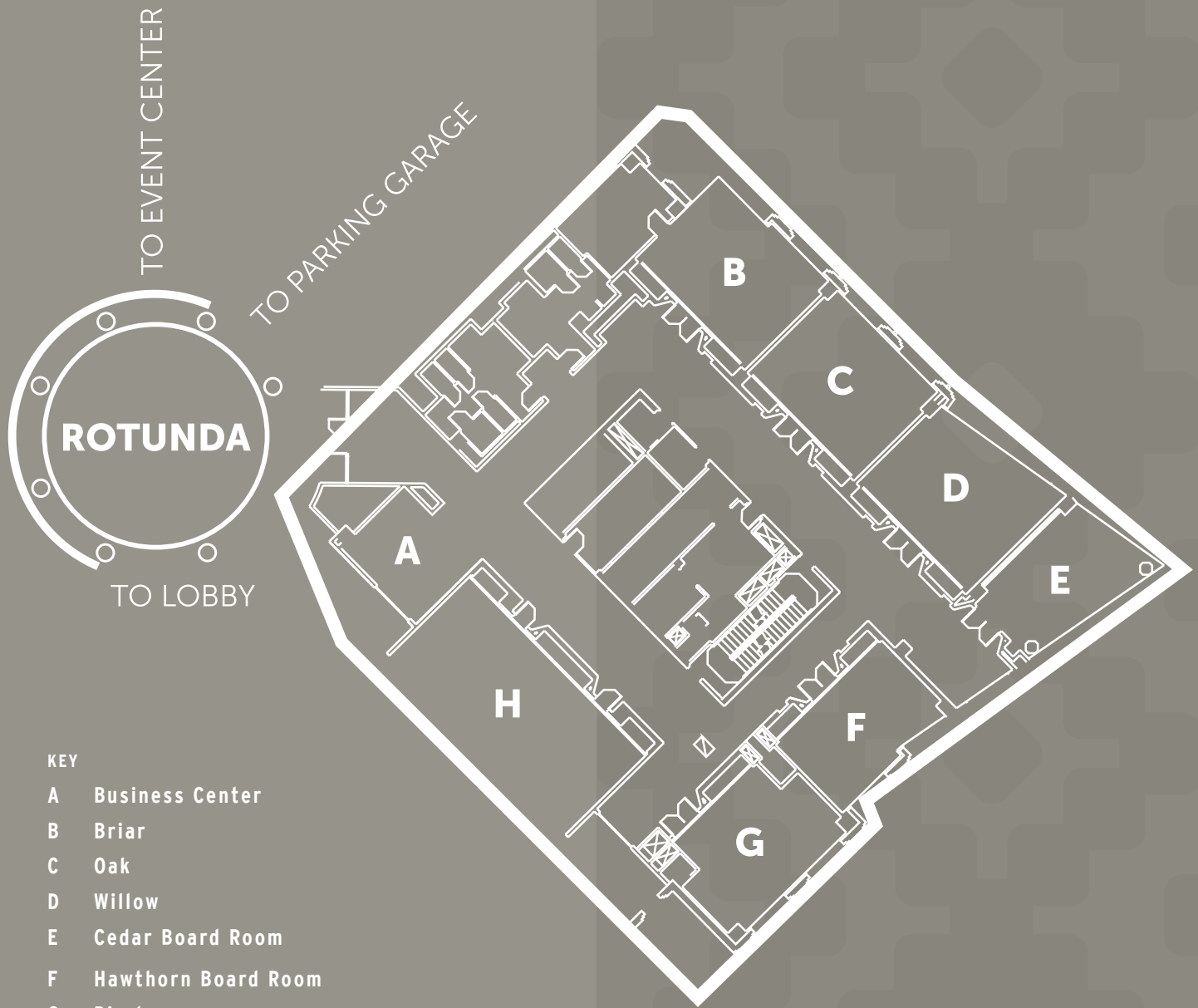

KEY

- A Business Center
- B Briar
- C Oak
- D Willow
- E Cedar Board Room
- F Hawthorn Board Room
- G Birch
- H Meadow

ROOM	DIMENSIONS	THEATER	CLASSROOM	BANQUET	SQ. FT.
Briar	21'x26'	50	22	40	581
Oak	21'x26'	46	24	40	571
Willow	26'x34'	46	24	40	587
Cedar Board Room	24'x18'	N/A	N/A	N/A	407
Hawthorn Board Room	17'x25'	N/A	N/A	N/A	459
Birch	20'x27'	34	18	30	513
Meadow	21'x43'	75	36	50	944

MINIMUM CEILING HEIGHT - 10 FEET



Event Center

Do you need convention, exhibit or vendor space at your meeting? Your trade show, product launch or industry-wide meeting will fit into our 33,000 square foot Event Center. Also serving as a premier entertainment stage, this open space can be reconfigured for arena and theatre seating. The parking garage, Tower Meeting rooms and multiple back-of-the-house dressing rooms and storage/set-up areas are nearby. Loading dock access provides easy load-in. Escalators connect the Event Center with The Tower Lobby and the Showroom. The 15,000 square foot Event Center Atrium provides a bright, open space for registration, pre- and post-function gatherings, casual entertainment and celebrations.

- Over 48,000 sq. ft. of combined space
- Restrooms on the event floor and mezzanine levels
- Adjacent to the Atrium with ground level vendor load-in
- In-house public address system for the event floor
- Escalators connect with the Conference Center
- In-floor power supply

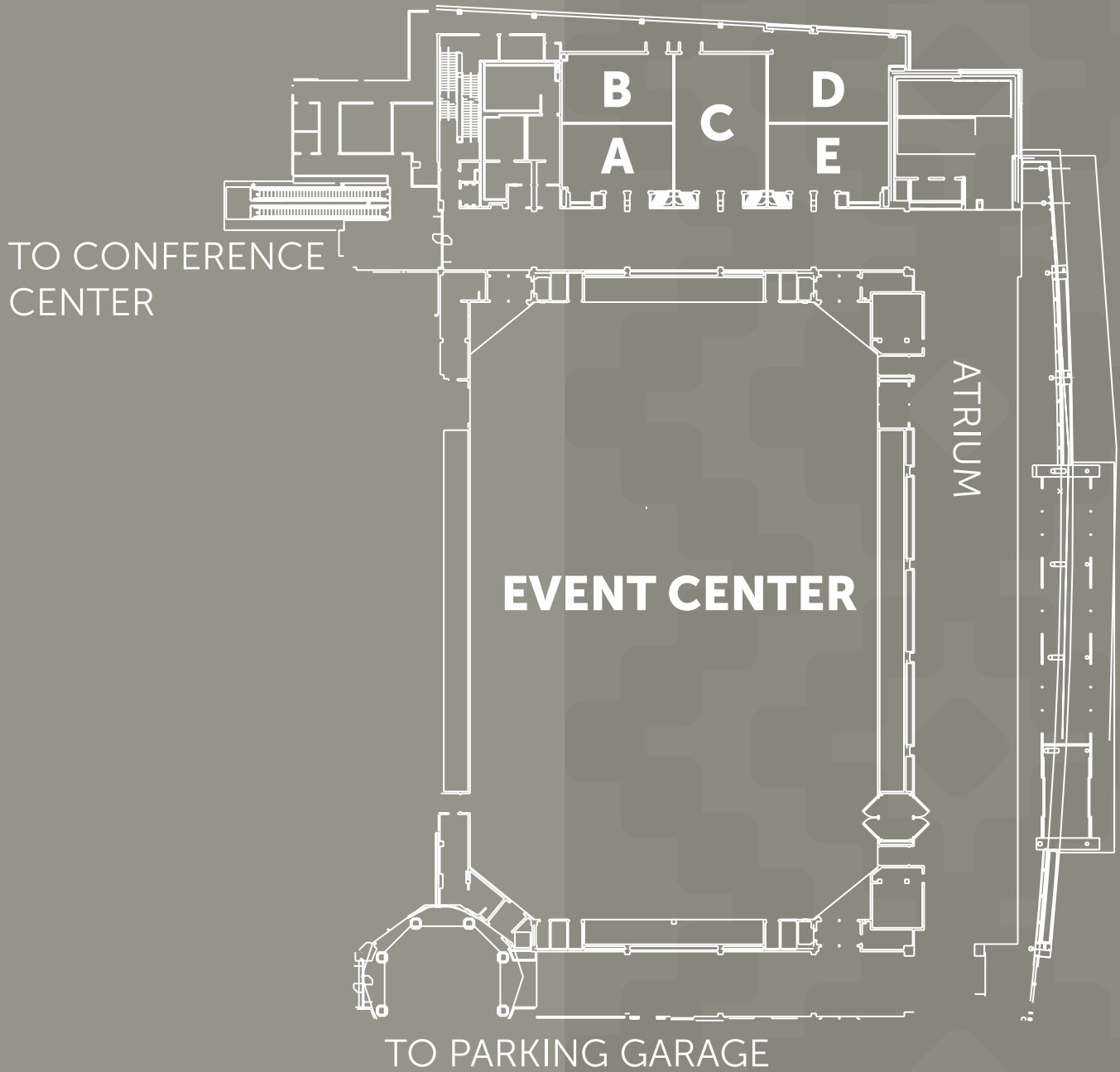

ROOM	DIMENSIONS	THEATER	CLASSROOM	BANQUET	SQ. FT.
Cypress A	23'x38'	50	36	46	933
Cypress B	23'x38'	60	36	46	893
Cypress C	47'x31'	126	72	72	1,509
Cypress D	23'x38'	72	57	72	1,346
Cypress E	23'x38'	50	42	60	1,024
Cypress A+B	47'x38'	126	84	72	1,826
Cypress D+E	56'x41'	180	108	144	2,370
Cypress Total	112'x56'	450	306	300	5,705
Event Center					29,868
Atrium					18,981

CEILING HEIGHT - 12 - 55 FEET



Shenendoah Clubhouse

Formal, quiet and beautiful—a favorite setting for weddings and banquets, the Clubhouse is adjacent to The Lodge on the Shenendoah Golf Course. This Tudor-style building provides beautiful views of the first and 18th holes from the windows and balconies. The main banquet room seats groups of up to 336. Enjoy a fire in the stone fireplaces during the winter months, or have a team lunch on the patio of The Grille at Shenendoah during golf season. Awards banquets, farewell luncheons, corporate golf challenges and working groups will all enjoy the refined atmosphere of the Clubhouse.

- A favorite site for formal weddings
- Expansive room with fireplace and balcony
- Convenient self parking
- Outdoor patio
- Located adjacent to The Lodge at Turning Stone and Skyline Spa
- Picturesque views of beautifully conditioned championship golf courses

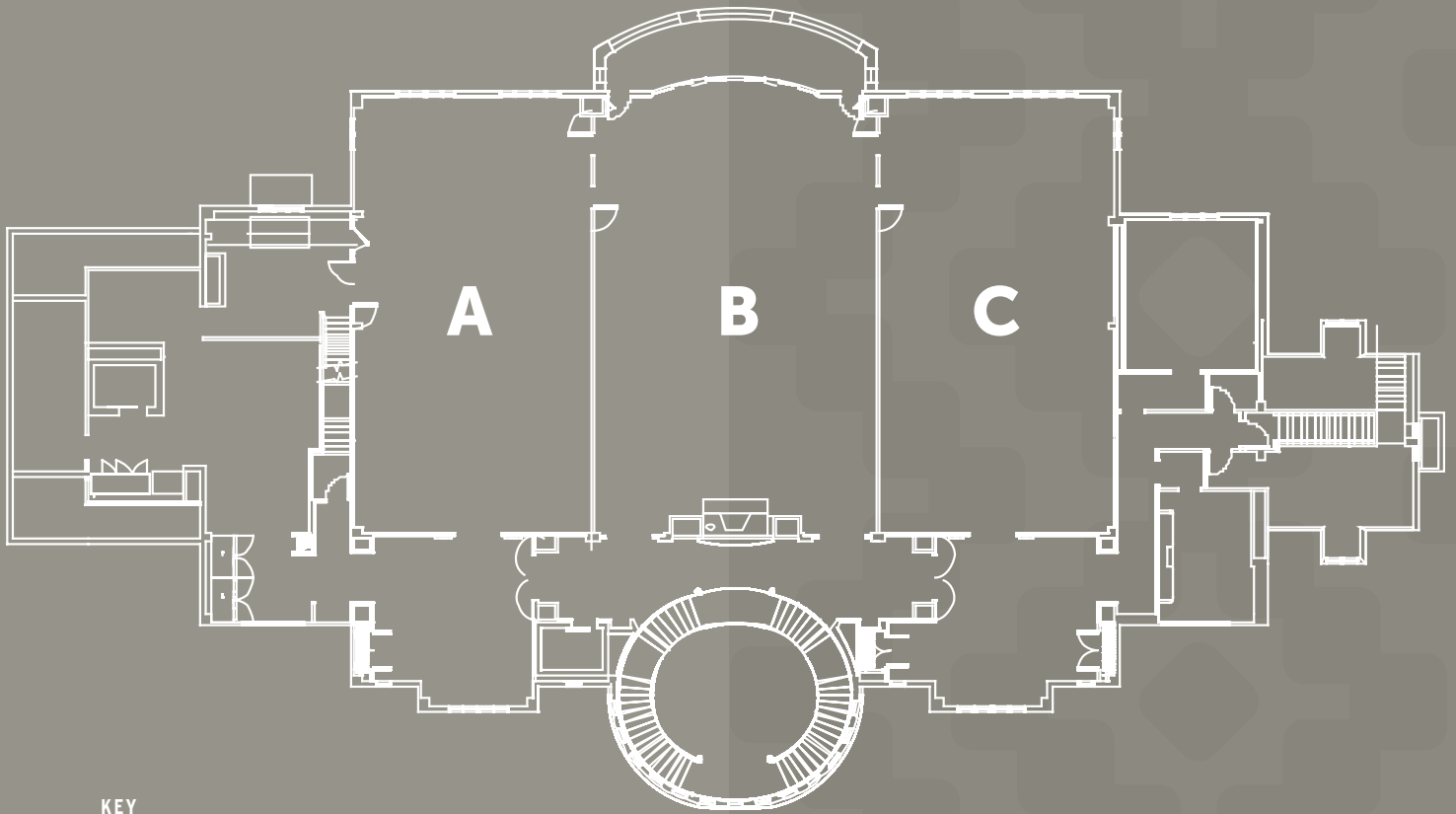

KEY

- A** Appalachian
- B** Adirondack
- C** Catskill

ROOM	DIMENSIONS	THEATER	CLASSROOM	BANQUET	SQ. FT.
Appalachian	32'x58'	154	84	96	1,851
Adirondack	38'x58'	176	84	108	2,221
Catskill	32'x58'	154	84	96	1,830
Combined	58'x102'	414	216	336	5,902

MINIMUM CEILING HEIGHT - 10 FEET

888.361.7958 OR 315.361.7958

5218 PATRICK RD, VERONA, NEW YORK 13478

TURNINGSTONE.COM

Turning Stone[®]
RESORT | CASINO

PROUDLY OWNED AND OPERATED BY THE ONEIDA INDIAN NATION