



# Meetings That Hit Big

*Turning Stone*<sup>®</sup>  
RESORT | CASINO



# A Destination That Inspires

**The natural beauty of Central New York's heartlands blends seamlessly with world-class amenities at Turning Stone Resort Casino, winner of the Forbes Travel Guide Four-Star Award and AAA Four Diamond Award.**

- 125,000 square feet of meeting space
- 788 guest rooms, from comfortable and affordable to lavish and luxurious
- Flexible, contiguous rooms for general sessions and breakout sessions
- 20+ dining options, from fine dining to quick and convenient
- Two luxury spas for relaxation and rejuvenation
- Three award-winning golf courses
- 10+ nightlife options featuring live music, cocktails and more
- Centrally located — easy travel by air, car or rail







# Lodging That Elevates

## The Lodge at Turning Stone

Our gorgeous woodland retreat offers elegant luxury suites with separate workspaces.

## The Tower at Turning Stone

Contemporary, stylish rooms and suites with panoramic views — topped with the award-winning TS Steakhouse on the penthouse floor.

## The Brook at Turning Stone

Located at the heart of the resort, The Brook offers rooms and suites with convenient access to meetings, dining and more.

## Sandstone Hollow Inn at Turning Stone

This relaxed, friendly inn is a short, complimentary shuttle ride from the main campus.

## The Inn at Turning Stone

Comfortable, affordable rooms and a staff who make you feel welcome. You can also enjoy a complimentary breakfast and complimentary shuttle ride to the casino.

## The Crescent

Soon a magnificent new hotel will offer 258 thoughtfully appointed rooms that leave no element of indulgence untended — and a signature, indoor-outdoor seafood restaurant.



# Dining That Wows

**Enjoy private dining for groups and indulge in culinary excellence at your choice of over 20 signature restaurants.**

## Wildflowers

Honored with the AAA Four Diamond Award and the Forbes Travel Guide Four-Star Award, Wildflowers sets the standard for atmosphere and culinary excellence with locally sourced, seasonal dishes.

## TS Steakhouse

TS Steakhouse, located on the 21st floor of The Tower, features classic cuts, chops and cocktails with panoramic views, fine cigars and spirits.

## Peach Blossom

Peach Blossom combines Chinese and Thai cuisine with variety, freshness, sweet and spicy flavors. Our chefs create artistic and succulent dishes that satisfy your palate and delight your eyes.

## Pino Bianco

Pino Bianco, located in the center of the resort, is an Italian-style restaurant where dinner is served up in a casual yet sophisticated setting.

## The Upstate Tavern

From local ingredients to local brews, the menu offers culinary creations that are time-honored, New York-inspired, and familiar American classics prepared from scratch.







### 7 Kitchens

A station-style buffet with a robust menu to appeal to every palate. Choose from Asian, Italian, Mediterranean, seafood, tacos, meats, the grill and desserts.

### NY Rec & Social Club

Unleash your competitive spirit, savor signature cocktails and win over your hunger. Epic eats, ranging from shareable snacks to gourmet delights, hit the spot every time.

### The Food Hall at Turning Stone

Stop in at the Food Hall for six unique dining options ranging from hot corned beef sandwiches to margherita pizza, General Tso's chicken, Philly burgers, fried chicken and shredded pork quesadillas.

### Sushi Sushi

A variety of Sashimi, Nigiri and Maki rolls are handcrafted by our Sushi Chef — featuring his daily selection of the highest-quality fish and steaming Asian Noodles. Take a seat and enjoy the art of sushi making.

### Emerald Restaurant

Emerald serves casual fare in a comfortable, relaxed setting. Choose from a classic American menu ranging from breakfast to fresh salads, sandwiches, burgers and dinners, available for dine-in and takeout 24 hours a day.

### Tin Rooster Honky Tonk

At Tin Rooster, the pig is sacred, the beer is cold and the atmosphere is country Americana at its finest. Our BBQ features signature flavors that may start a finger-lickin' obsession.

### Opals Confectionery

Indulge in fresh hot coffee, a just baked muffin or house-made fudge at Opals. A tempting array of rich confections will satisfy your sweet tooth.

### The Grille at Shenendoah

Grab a bite in this stone-and-cedar-style clubhouse. The Grille at Shenendoah features a full breakfast menu. Open seasonally with outdoor al fresco dining.

### Tower Lounge

Enjoy a vibrant atmosphere and a wonderful selection of cocktails and nosh-ready snacks.

### The Lodge Lounge

The bar provides panoramic views of the western sky overlooking The Great Lawn. This beautiful spot offers sunsets, spirits and savory spreads.





# Meeting Spaces That Impress

**125,000 square feet of flexible meeting space, with unobstructed views for impactful general sessions and breakouts.**

## The Conference Center

Large or small, your group will find the perfect fit in our Conference Center. There's plenty of room for keynotes, exhibits, seminars, meals, meetings and even company celebrations — all staffed by our consummate service professionals in a grand ballroom setting.

- 22,500+ sq. ft.
- State-of-the-art technology and in-house AV support
- Breakout meeting rooms with flexible configurations
- Accommodates banquets for up to 800 guests
- Ground-level load-in access
- Private registration desk





## Cypress Ballroom

A natural light-filled space that works exceptionally well for large meetings, elegant corporate celebrations and effective training events, The Cypress Ballroom is adjacent to The Event Center. Used as a single session or divided into as many as five breakout spaces, it is a versatile resource for any program.

- 5,700+ sq. ft.
- Flexible configuration
- Beautifully furnished

## The Showroom

Ideal for keynote addresses, The Showroom offers state-of-the-art lighting and sound, a luxurious bar and exceptionally comfortable theater seating.

- Stadium-style seating
- Accommodates up to 650 guests

## The Event Center

A truly majestic space, The Event Center offers a 30,000-square-foot exhibit floor that can be configured to match your most specific needs. It also includes the 15,000-square-foot Atrium provides an ideal setting for registration and other pre-function activities.

- Including the Atrium, 49,000+ sq. ft.
- In-house public address system for the event floor
- In-floor power supply
- Can host up to 1,200 guests for dinner
- Accommodates up to 180 10x10' booths







### Shenendoah Clubhouse

The Clubhouse is a favorite setting for executive board retreats, incentive meetings and corporate celebrations. This one-of-a-kind meeting space is steps away from the main resort.

- 5,900 sq. ft. that can be used as a single session or three breakouts
- Expansive room with fireplace and balcony
- Convenient self-parking
- Outdoor patio
- Adjacent to The Lodge
- Picturesque fairway views

### The Lodge Boardroom

The Lodge Boardroom eclipses traditional meeting spaces by providing a serene space with private access to the scenic Great Lawn. The Boardroom is fully loaded with high-tech amenities and expert staff ready to assist.

- Seats up to 14
- Executive leather chairs
- Extensive charging ports
- Built-in telecommuting technology
- Large LCD video monitor
- Automated black-out shades for enhanced presentation clarity



### Tower Meeting Rooms

Perfect for small-group discussions, seminars and boardroom-style meetings, The Tower lends your gathering the right combination of intimacy, convenience and sophistication. These natural light-filled and fully equipped rooms serve as the ideal space for intimate receptions.

- Seven boardroom-style meeting rooms from 400 to 900+ sq. ft.
- Easy access to the parking garage, the hotels, Conference Center and dining



# The Conference Center

## Specifications

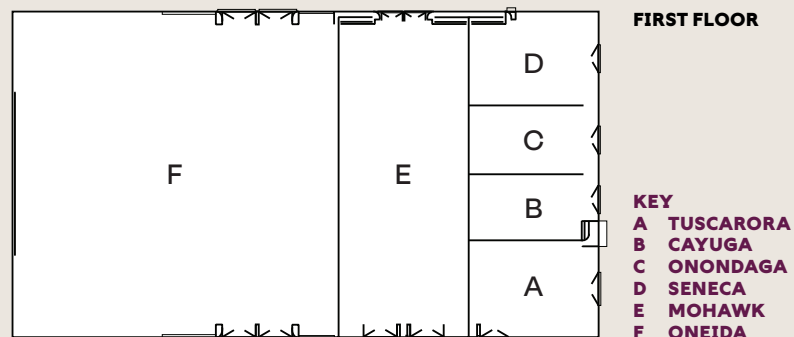

ROOM	DIMENSIONS	THEATER	CLASSROOM	BANQUET	SQ. FT.
Tuscarora	37'x55'	126	72	60	1,579
Cayuga	27'x51'	108	63	50	1,337
Onondaga	26'x51'	108	63	50	1,252
Seneca	33'x51'	126	72	60	1,609
Mohawk	116'x45'	540	270	230	5,212
Oneida	132'x101'	624	514	400	11,465
Combined	119'x196'	1,632	1,054	850	22,500

MINIMUM CEILING HEIGHT — 12 - 16 FEET

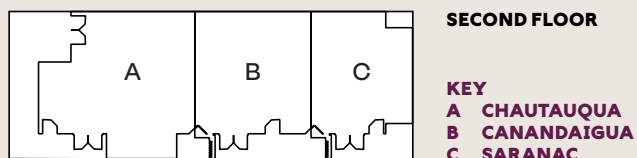

ROOM	DIMENSIONS	THEATER	CLASSROOM	BANQUET	SQ. FT.
Chautauqua	31'x32'	49	27	40	836
Canandaigua	25'x24'	40	27	30	618
Saranac	25'x21'	45	27	20	499
Combined	36'x80'	144	81	90	1,953

MINIMUM CEILING HEIGHT — 10 FEET

# Cypress Ballroom

## Specifications

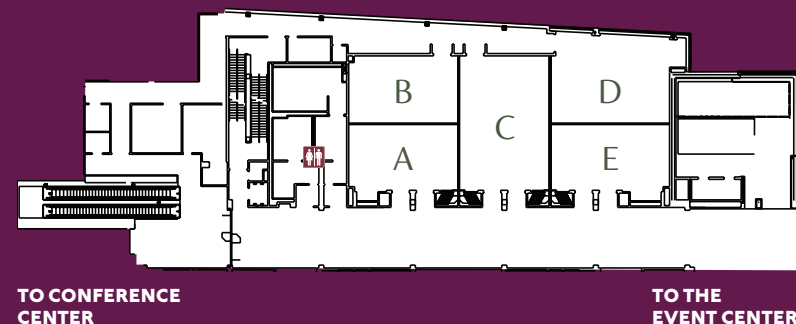

ROOM	DIMENSIONS	THEATER	CLASSROOM	BANQUET	SQ. FT.
Cypress A	23'x38'	50	36	40	933
Cypress B	23'x38'	60	36	30	893
Cypress C	47'x31'	126	72	60	1,509
Cypress D	23'x38'	72	57	40	1,346
Cypress E	23'x38'	50	42	40	1,024
Cypress A+B	47'x38'	126	84	60	1,826
Cypress D+E	56'x41'	180	108	90	2,370
Cypress Total	112'x56'	450	306	230	5,705

CEILING HEIGHT — 12 - 55 FEET



# The Event Center

## Specifications

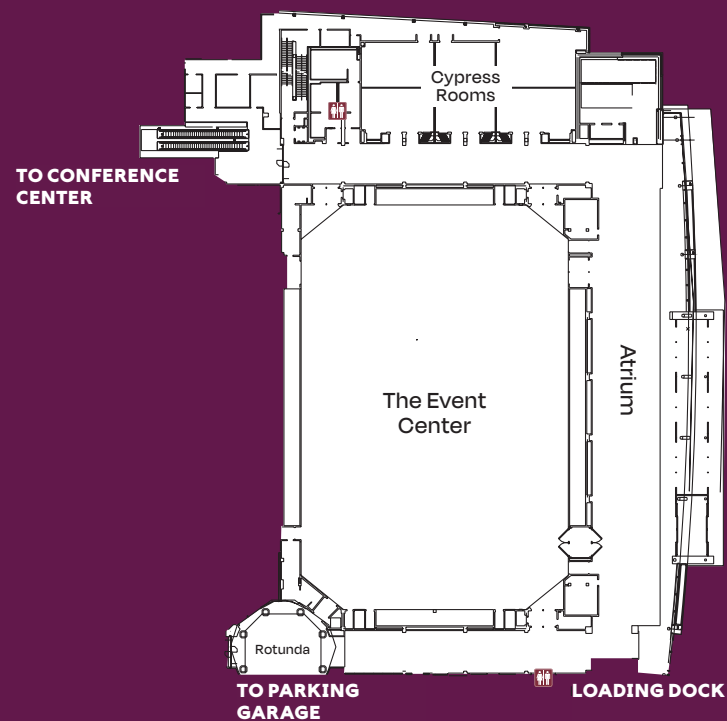

ROOM	SQ. FT.
The Event Center	29,868
Atrium	18,981
CEILING HEIGHT — 12 - 55 FEET	

# Shenendoah Clubhouse

## Specifications

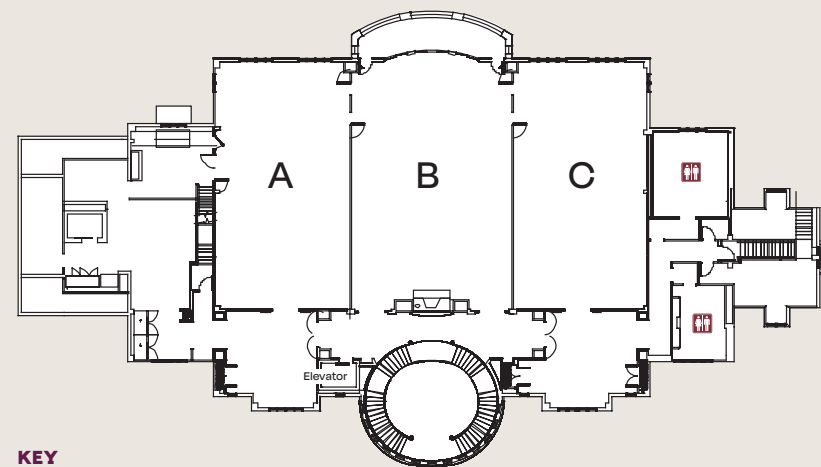

**KEY**  
**A APPALACHIAN**  
**B ADIRONDACK**  
**C CATSKILL**

ROOM	DIMENSIONS	THEATER	CLASSROOM	BANQUET	SQ. FT.
Appalachian	32'x58'	154	84	70	1,851
Adirondack	38'x58'	176	84	90	2,221
Catskill	32'x58'	154	84	70	1,830
Combined	58'x102'	414	216	230	5,902
MINIMUM CEILING HEIGHT — 10 FEET					



# The Lodge Boardroom

## Specifications

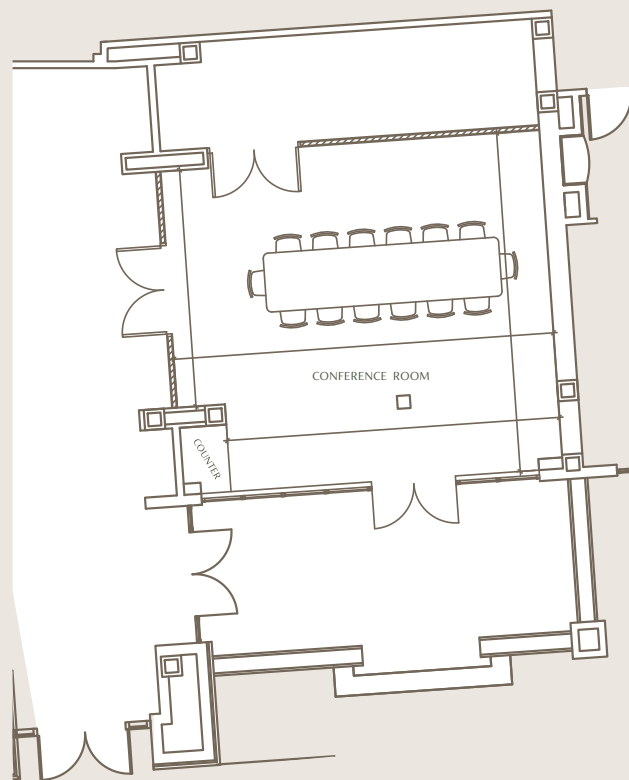

DIMENSIONS	CAPACITY	SQ. FT.
22'x25'	14	550
MINIMUM CEILING HEIGHT — 10 FEET		

# The Tower Meeting Rooms

## Specifications

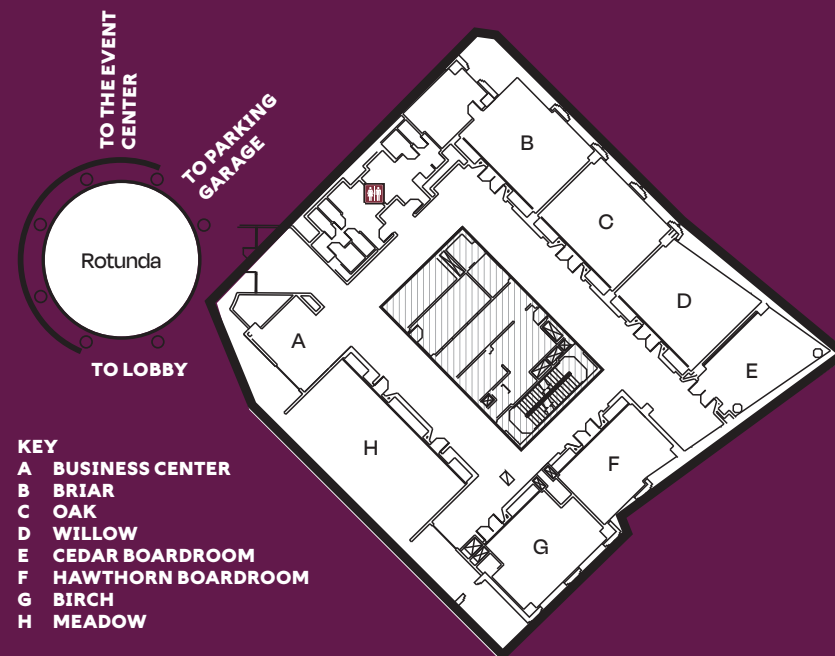

ROOM	DIMENSIONS	THEATER	CLASSROOM	BANQUET	SQ. FT.
Briar	23'x26'	50	22	30	581
Oak	23'x26'	46	24	30	571
Willow	26'x35'	46	24	30	587
Cedar	27'x19'	N/A	N/A	N/A	407
Hawthorn	19'x25'	N/A	N/A	N/A	459
Birch	22'x27'	34	18	20	513
Meadow	24'x43'	75	36	40	944
MINIMUM CEILING HEIGHT — 10 FEET					





# Award-Winning Golf

- Three world-class and two executive courses
- The Sportsplex at Turning Stone is open all year for practice, lessons and more
- Group lessons available

## Atunyote

The parkland setting of Atunyote features vast stretches of open space, gently rolling hills, a stream of small waterfalls and several lakes. Walk the fairways that past PGA champions have walked.

## Shenendoah

Experience 18 holes of PGA-level golf in a spectacular natural setting with wooded parkland holes and open pastures that capture the links feel. Designed, constructed and maintained to tour standards at more than 7,000 yards, the course offers conditions normally reserved for tour professionals.

## Kaluhyat

Measuring in at just over 7,100 yards, Kaluhyat is ranked as a Top Casino Course by Golfweek. The course is marked by dramatic changes in elevation, with plateau settings offering seemingly endless views of the surrounding terrain. The course is a classic shot-maker's course, where accuracy and strategy are rewarded as much as length.



# Relaxation and Recreation

## Spas

- Sk̓an̓a: The Spa at Turning Stone, awarded four stars by Forbes Travel Guide
- Áh̓si' Day Spa

## Outdoor Recreation

### Salmon Acres

36 acres on the banks of the world-renowned Salmon River. This could well be the finest salmon fishing you'll ever experience.

### Sylvan Beach Supply Co.

Located on beautiful Oneida Lake, Sylvan Beach Supply Co. offers rentals of boats, kayaks, paddle boards, fishing gear, bikes and more.





# Nightlife at Exit 33

**From live rock bands to luxurious lounges, we've got it all when it's time for your team to kick back. Available for private events or eclectic breakout meetings.**

## NY Rec & Social Club

Our new social club experience. Come for good times, great games, epic eats and signature cocktails.

## Alchemist Bar

The perfect spot for a meet-up or casual sit-and-sip, serving specialty cocktails, crafted drinks and imported and domestic beers.

## Tin Rooster Honky Tonk

Country and Americana at its finest. Giddy up!

## Turquoise Tiger

A 1940s Film Noir-inspired lounge.

## The Gig

Your neighborhood rock 'n' roll joint — right down the hall from your meeting.

## Exit 33 Courtyard

Located right outside all the nightlife happenings, featuring patio seating, a fire pit, twinkling lights and a full bar. Open seasonally.



# Exit 33

## Specifications

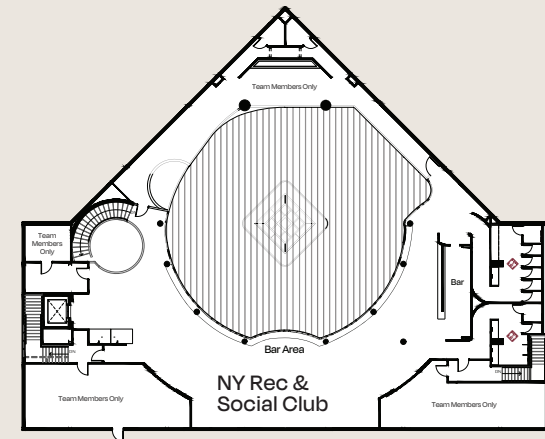
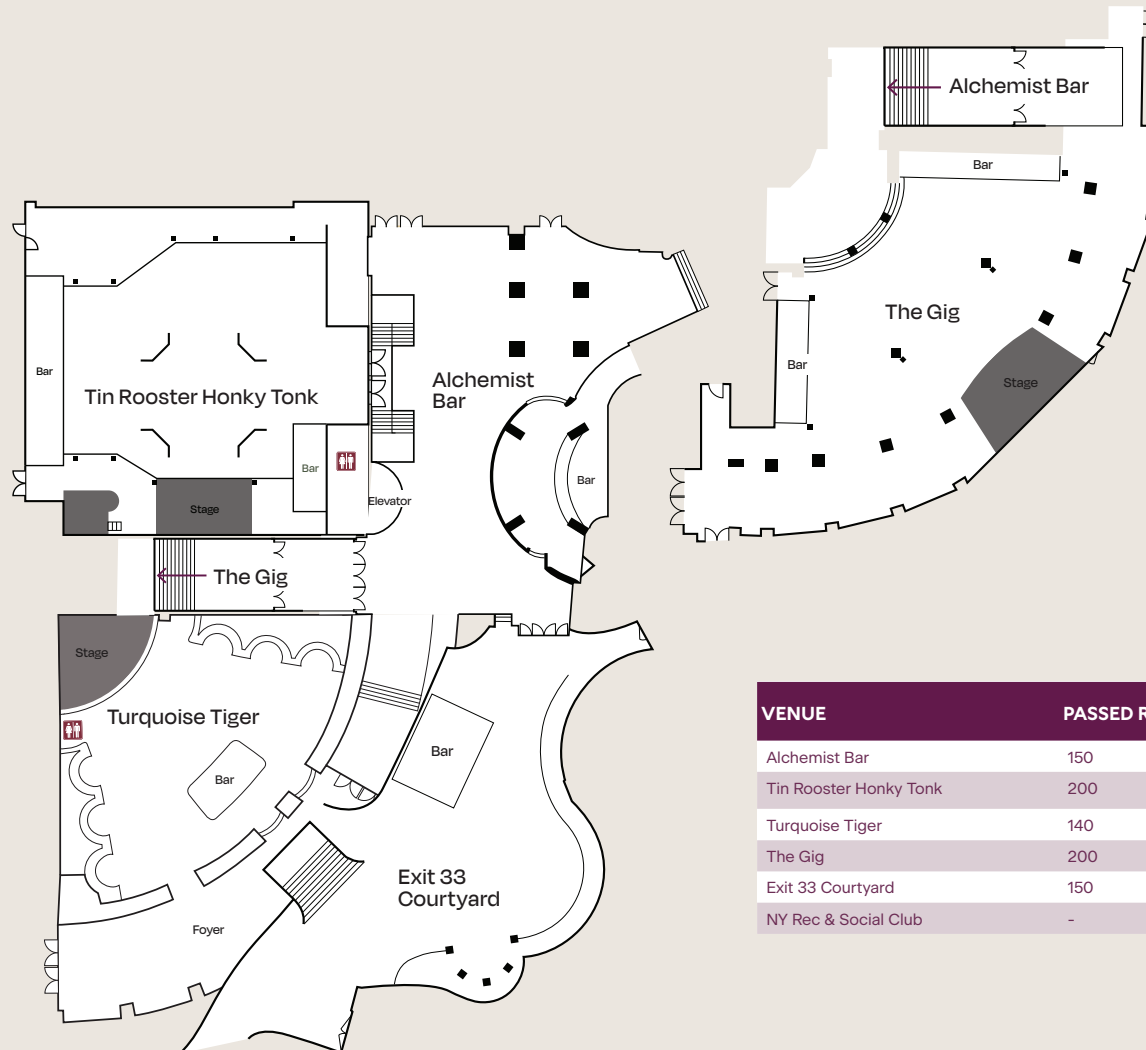

VENUE	PASSED RECEPTION	STATION RECEPTION	BANQUET
Alchemist Bar	150	100	90
Tin Rooster Honky Tonk	200	200	138
Turquoise Tiger	140	120	-
The Gig	200	200	100
Exit 33 Courtyard	150	100	50
NY Rec & Social Club	-	101	-



# Property Maps

## Overall Specifications

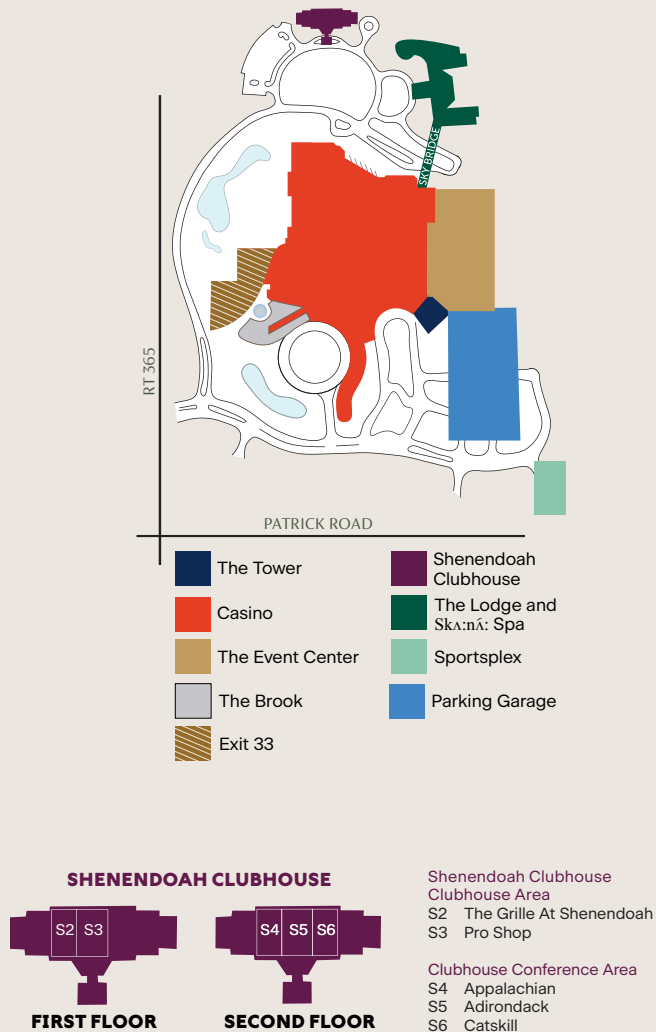

## Detail Specifications

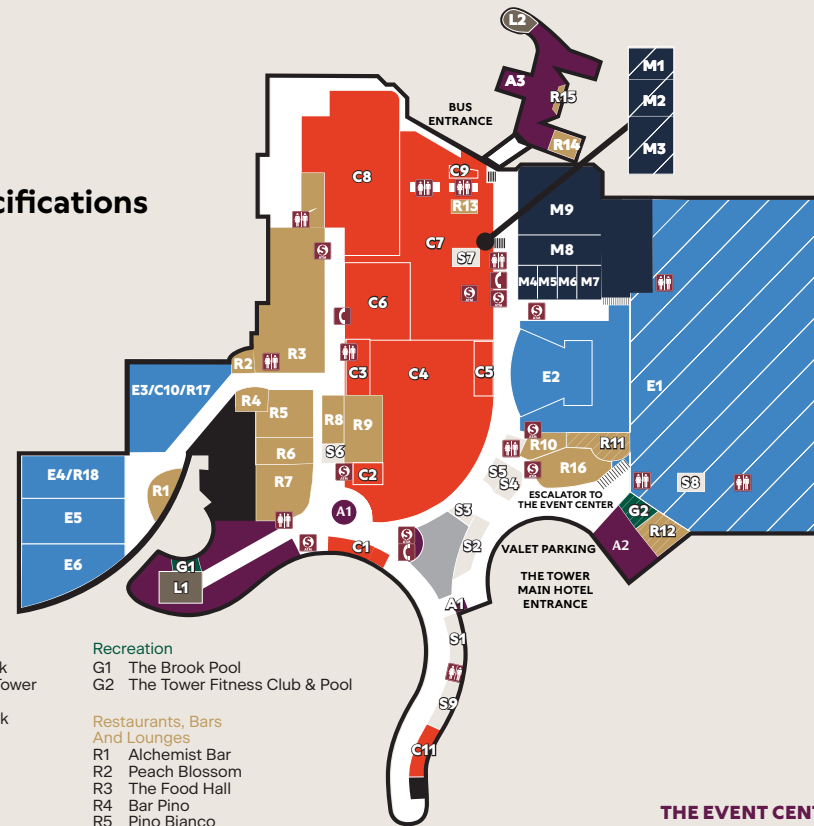

**Accommodations**  
A1 Elevator To The Brook  
A2 The Brook And The Tower Front Desk  
A3 The Lodge Front Desk

**Convention Center**  
M1 Saranac  
M2 Canandaigua  
M3 Chautauqua  
M4 Tuscarora  
M5 Cayuga  
M6 Onondaga  
M7 Seneca  
M8 Mohawk  
M9 Oneida

**Entertainment**  
E1 The Event Center  
E2 The Showroom  
E3 NY Rec & Social Club  
E4 Tin Rooster Honky Tonk  
E5 The Gig  
E6 Turquoise Tiger

**Gaming**  
C1 TS Guest Services  
C2 Golden Dragon  
C3 Keno  
C4 Casino Gaming Floor  
C5 Casino Cashier  
C6 Poker Room  
C7 Casino Blu  
C8 High Stakes Bingo  
C9 Gaming Commission  
C10 TS Sports  
C11 The Parlor – Members Only

**Recreation**  
G1 The Brook Pool  
G2 The Tower Fitness Club & Pool

**Restaurants, Bars And Lounges**  
R1 Alchemist Bar  
R2 Peach Blossom  
R3 The Food Hall  
R4 Bar Pino  
R5 Pino Bianco  
R6 Sushi Sushi  
R7 Emerald Restaurant  
R8 Opals Confectionery  
R9 Motif Bar & Lounge  
R10 7 Kitchens  
R11 The Upstate Tavern  
R12 TS Steakhouse (21st Floor of The Tower)  
R13 Bar Blu  
R14 Wildflowers  
R15 The Lodge Bar  
R16 Tower Lounge  
R17 NY Rec & Social Club  
R18 Tin Rooster Honky Tonk

**Retail**  
S1 Oneida Heritage  
S2 Polly Cooper  
S3 Juniper  
S4 Revel Supply  
S5 Willow & Jaye  
S6 The Kiosk  
S7 Smokin' 2  
S8 The General Store  
S9 Mr. Shop

**Spa**  
L1 Åhsí' Day Spa  
L2 Skā:nā: Spa

### Convention Center

**The Tower Meeting Rooms**  
T1 Business Center  
T2 Meadow  
T3 Birch  
T4 Hawthorn  
T5 Cedar  
T6 Willow  
T7 Oak  
T8 Briar

**Entertainment**  
T9 TS Guest Services  
T10 The Event Center

**Cypress Conference Area**  
T11 Cypress A  
T12 Cypress B  
T13 Cypress C  
T14 Cypress D  
T15 Cypress E

### THE EVENT CENTER SECOND FLOOR

